

HALUX LED 20-3 EXAMINATION LIGHT



Derungs 
LIGHT FOR PEOPLE

fitted with	1 x LED lamp
Illuminance field 0,5 m	Ø 18 cm
Color Rendering Index (CRI)	> 93
colour temperatur	4400 K / 3800 K / 3300 K
work equipment	electronic converter
connected load	100-240 V; 50/60 Hz
mains lead	1.8 m UK
luminaire body	polycarbonate (PC)
weight (net)	1.4 kg
power consumption	18 W
usage	keypad at luminaire head
balance of articulation joints	spring
class of protection	II
accessory	roll support, table clamp with removal protection, universal fastening with removal protection, extension arm with removal protection, wall bracket with removal protection
norms	EN 60601-1, EN 60601-2-41
special features	3 color shades, 5 dimming levels, maintenance free
fastening	rail, table, wall
order number	D15493000 - pure white

light distribution

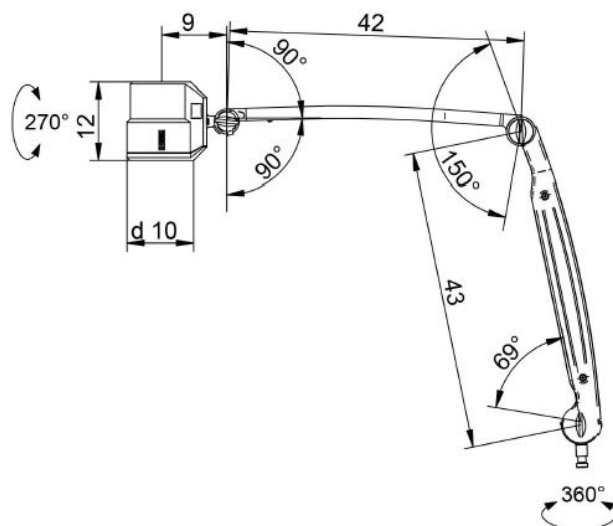
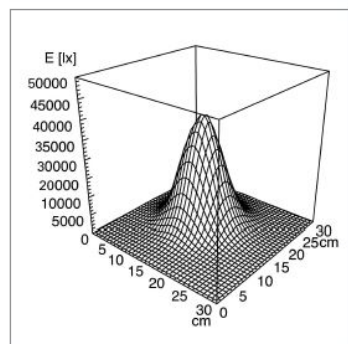

Medical and Surgical Requisites Pty Ltd

Call within Brisbane 07 3859 2900
Phone 1300medsurg (1300 633 787)

33 Fulcrum Street Richlands Queensland 4077
Email medical@medsurg.com.au

www.medsurg.com.au
Fax 07 3859 2995

